

# HLS6513 Technical Specification

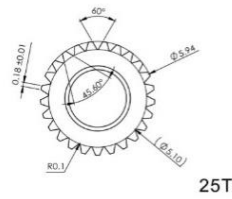

6mm25T Output Shaft Spline

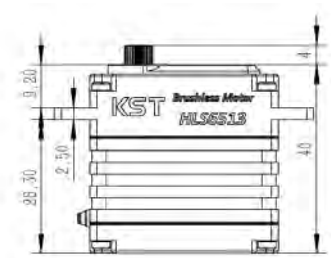
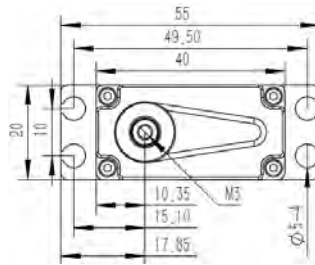

## 1. Operating Data

## 2. Performance

HLS6513	
Rated Voltage	DC7.40V
Voltage Range	DC6.00V-8.40V
Stalling Torque	55.0Kgf.cm@6.00V
	65.0Kgf.cm@7.40V
	70.0Kgf.cm@8.40V
No-load Speed	0.16sec/60°@6.00V
	0.13sec/60°@7.40V
	0.11sec/60°@8.40V
Working Frequency	1520us/333Hz
Default Travel Angle	±100°=200° Total Travel
Temperature Range	-10°C .....+65°C
Soft Start	Programmable
Programmable	Yes
Case Material	Aluminum Alloy
Motor Type	4Pole Brushless Motor
Gear Set Material	Hardened Steel
Position Sensor	Contactless
Ball Bearing	6BB
Case Dimensions	40*20*40mm±0.2mm
Weight	75g±10%

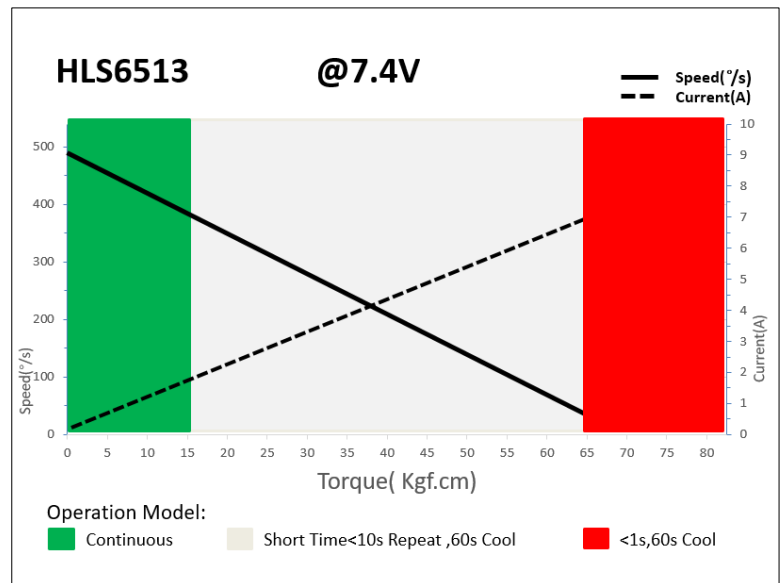

## 3. Command signal

### PWM Command Interface

Signal Voltage	HIGH: min.3.3V, max.5.0V Low: min.0.0V, max.1.5V
Pulse Lengths	500us-2500us
Pulse Lengths for Position	500us/1500us/2500us -100°/ 0°/+100°

## 4. Electrical Connection

 3 2 1	Pin Assignment			
	1	Orange	Signal	PWM Command
	2	Red	DC+	Supply Voltage
	3	Brown	DC-	Supply Ground