

CM3510MG V6.0 180° Version Technical Specification

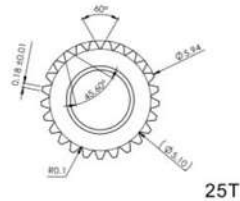

6mm25T Output Shaft Spline

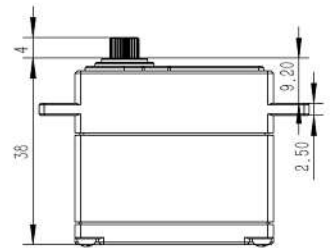
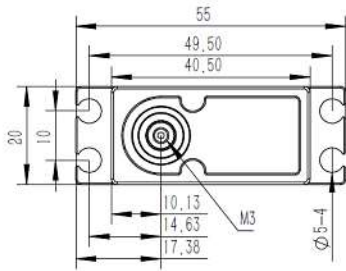

1. Operating Data

| | |
|----------------------|------------------------|
| Rated Voltage | DC7.4V |
| Voltage Range | DC4.8V-8.4V |
| Stalling Torque | 20Kgf.cm@4.8V |
| | 25Kgf.cm@6.0V |
| | 30Kgf.cm@7.4V |
| | 35Kgf.cm@8.4V |
| Speed | 0.20sec/60°@4.8V |
| | 0.15sec/60°@6.0V |
| | 0.13sec/60°@7.4V |
| | 0.10sec/60°@8.4V |
| Current | 2.10A@4.8V |
| | 2.90A@6.0V |
| | 3.30A@7.4V |
| | 3.65A@8.4V |
| Working Frequency | 1520us/333Hz |
| Default Travel Angle | ± 90° = 180° Total |
| Temperature Range | -10°C.....+65°C |
| Soft Start | Programmable |
| Programmable | Yes |
| Motor Type | Coreless DC Motor |
| Gear Set Material | Hardened Steel Gear |
| Position Sensor | Potentiometer |
| Ball Bearing | 2BB |
| Waterproof | IP65 |
| Case Dimensions | 40.5mm*20mm*38mm±0.2mm |
| Case Material: | CNC Aluminum Case |
| Weight | 70g±10% |

2. Performance

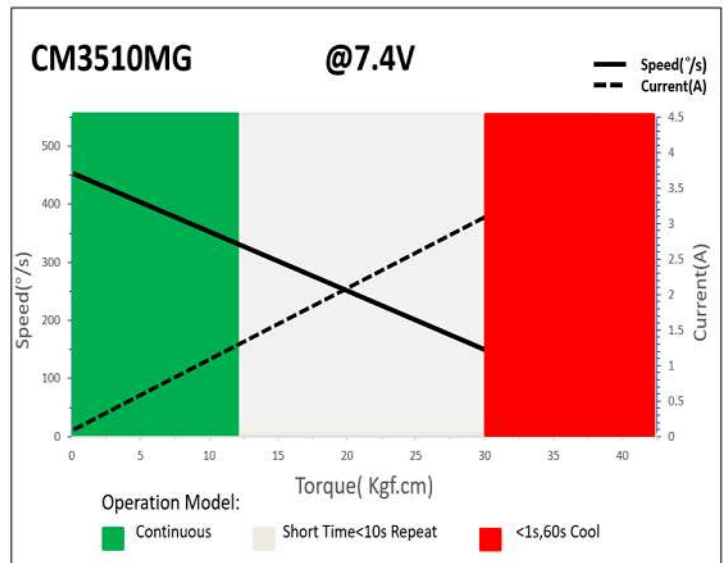

3. Command signal PWM Command Interface

| | |
|----------------------------|---|
| Signal Voltage | HIGH: min.3.3V, max.5.0V Low: min.0.0V, max.1.5V |
| Pulse Lengths | 900us-2100us |
| Pulse Lengths for Position | 1000us/1500us/2000us -50°/0°/+50° |

4. Electrical Connection

| Pin Assignment | | | |
|----------------|---|--------|--------------------|
| | 1 | Orange | Signal PWM Command |
| | 2 | Red | DC+ Supply Voltage |
| | 3 | Brown | DC- Supply Ground |